



**Euronda®**  
Pro System

Eurosafe 60

ENGLISH

## INDEX

Effective and efficient at the same time.	05
Problem-free disinfection for everything.	07
Quick, simple and customizable.	09
Complete, secure traceability.	11
Preset thermal disinfection cycles	12
Operating stages	12
Accessories	13
Technical insight	16
Technical specifications	18

## Euronda

For you who love to surround yourself with beautiful things,  
even when you're working. For you who hate complications.

For you who put safety before everything else.

For you who love well made things that last over time.

For you who want only the best...



## Effective and efficient at the same time.

The Eurosafe 60 washer disinfecter complements the Euronda Sterilization line. In a single cycle, it pre-washes, washes, thermally disinfects and dries, so there is no need to clean by hand. It takes less time and less effort to produce effective, efficient results with Eurosafe 60. It prevents staff from being exposed to the risks of handling contaminated instruments and it is environmentally friendly, thanks in part to the automatic dispenser that adjusts the amount of detergent used. There are two Eurosafe 60 models: one with an automatic enzymatic detergent peristaltic pump for thorough instrument cleaning, and one with two automatic peristaltic pumps, one of which is for instrument rinse aid.

● Focus on the topic  
➤ - **AUTOMATIC DETERGENT DISPENSER**  
page 14



PREWASHING



WASHING

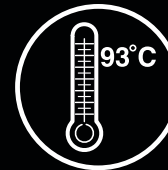

THERMAL DISINFECTION

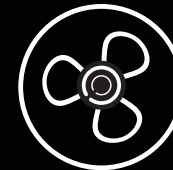

DRYING



28.10.15 12:40 00000  
SHORT B7  
21.9° A0 21.9° A0  
SP ---\* ---\*  
- porta aperta -



# Problem-free disinfection for everything.

Thanks to its large, 60-litre tank, Eurosafe 60 can be used to disinfect many items, including wands, loose instruments and containers. The hot-air drying system ensures that all traces of water are removed from both outside and inside hollow instruments. Everything about Eurosafe 60 is designed to guarantee maximum safety, from the AISI 316L stainless steel washing arms and washing chamber with rounded edges to the safety system to prevent the door from being opened during washing. There is a comprehensive range of accessories, including trays, baskets, wand holders and adaptors.

● Focus on the topic  
➔ - **FORCED HOT AIR DRYING**  
page 14







28.10.15 16:40 00001

MENU

PROGRAMMA 8

STANDARD

SS Y7.05





# Quick, simple and customizable.

Eurosafe 60 makes thermal disinfection a simple, pleasant process thanks to its user-friendly interface, with an LCD display and control panel that are extremely easy to utilize. You can set the buttons under the display to start your three favourite cycles so that they can always be selected instantly. There is also a choice of 17 other preset cycles. In addition, it is possible to programme a further 20 cycles that can be customized to match your needs and materials. Settings such as the washing time and temperature can be adjusted and then protected with a password.

➤ Focus on the topic  
- **PASSWORD-PROTECTED PERSONAL CYCLES**  
page 14



STANDARD

SS V7.05



P1

P2

P3

PRG



## Complete, secure traceability.

With Eurosaf 60, you can record details of all of the disinfection cycles that you run, by saving them on a USB flash drive, transferring them onto a computer with the Ethernet connection or printing them with the optional printer so that they are immediately available. This guarantees validation and documentation of the disinfection process, which can be carried out by up to 30 different password-authenticated users.

● Focus on the topic  
➤ - **CYCLE TRACEABILITY WITH MANAGEMENT SOFTWARE**  
page 15



Ciclo	Fecha	Hora	Temperatura	Humedad	Presión	Velocidad	Estado
001	2023-10-27	10:00	22.5	65	1013	1.2	Completado
002	2023-10-27	10:15	22.5	65	1013	1.2	Completado
003	2023-10-27	10:30	22.5	65	1013	1.2	Completado
004	2023-10-27	10:45	22.5	65	1013	1.2	Completado
005	2023-10-27	11:00	22.5	65	1013	1.2	Completado
006	2023-10-27	11:15	22.5	65	1013	1.2	Completado
007	2023-10-27	11:30	22.5	65	1013	1.2	Completado
008	2023-10-27	11:45	22.5	65	1013	1.2	Completado
009	2023-10-27	12:00	22.5	65	1013	1.2	Completado
010	2023-10-27	12:15	22.5	65	1013	1.2	Completado
011	2023-10-27	12:30	22.5	65	1013	1.2	Completado
012	2023-10-27	12:45	22.5	65	1013	1.2	Completado
013	2023-10-27	13:00	22.5	65	1013	1.2	Completado
014	2023-10-27	13:15	22.5	65	1013	1.2	Completado
015	2023-10-27	13:30	22.5	65	1013	1.2	Completado
016	2023-10-27	13:45	22.5	65	1013	1.2	Completado
017	2023-10-27	14:00	22.5	65	1013	1.2	Completado
018	2023-10-27	14:15	22.5	65	1013	1.2	Completado
019	2023-10-27	14:30	22.5	65	1013	1.2	Completado
020	2023-10-27	14:45	22.5	65	1013	1.2	Completado
021	2023-10-27	15:00	22.5	65	1013	1.2	Completado
022	2023-10-27	15:15	22.5	65	1013	1.2	Completado
023	2023-10-27	15:30	22.5	65	1013	1.2	Completado
024	2023-10-27	15:45	22.5	65	1013	1.2	Completado
025	2023-10-27	16:00	22.5	65	1013	1.2	Completado
026	2023-10-27	16:15	22.5	65	1013	1.2	Completado
027	2023-10-27	16:30	22.5	65	1013	1.2	Completado
028	2023-10-27	16:45	22.5	65	1013	1.2	Completado
029	2023-10-27	17:00	22.5	65	1013	1.2	Completado
030	2023-10-27	17:15	22.5	65	1013	1.2	Completado

PRESET THERMAL DISINFECTION CYCLES

	SHORT	STANDARD	INTENSIVE
	P1	P2	P3
PRE-WASH	-	✓	✓
WASHING	50 °C	60 °C	65 °C
RINSING	-	✓	✓
THERMAL DISINFECTION	90 °C	90 °C	90 °C
DRYING	120 °C	120 °C	120 °C
TOTAL CYCLE TIME	45'	60'	75'

OPERATING STAGES

**PRE-WASH**  
THE COLD WATER USED IN THE PRE-WASH STAGE IS DEMINERALIZED IN A FILTERING PROCESS INVOLVING SELF-HEALING ACTIVE RESINS AND COMMON SALT.

**WASHING**  
IN THE WASHING STAGE, A POWERFUL PUMP PRODUCES MULTI-DIRECTION WATER JETS AT CONSTANT PRESSURE. TOGETHER WITH THE QUALITY OF THE AISI 316L STAINLESS STEEL WASHING CHAMBER, WASHING ARMS, FILTERS AND INTERNAL CIRCUIT, THE SYSTEM GUARANTEES EXCEPTIONAL WASHING RESULTS.

**RINSING**  
IN THE RINSING STAGE, THE DETERGENT IS REMOVED FROM THE LOAD. THERMAL DIS INFECTION THE THERMAL DISINFECTION STAGE CAN BE PROGRAMMED TO LAST BETWEEN 1 AND 10 MINUTES AND THE TEMPERATURE CAN BE SET AT UP TO 93°C. THE TEMPERATURE IS CONTROLLED BY TWO INDEPENDENT PT1000 SENSORS.

**DRYING**  
EFFECTIVE DISTRIBUTION OF THE FILTERED, FORCED HOT AIR IN THE CHAMBER ENSURES THAT ALL OF THE INSTRUMENTS AND HOLLOW ITEMS ARE DRIED PERFECTLY.

## STARTER KIT



- 1 HANBOOK
- 1 USB
- 1 WATER TEST
- 1 KG SALT
- EUROCLEAN 120 - 500 ML
- EUROBRIGHT 360 - 500 ML (INCLUDED JUST IN THE ONE PUMP VERSION).



INSERT FOR VERTICALLY POSITIONED INSTRUMENTS.

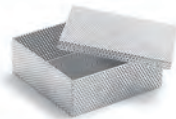

BASKET FOR BURS AND SMALL PARTS.

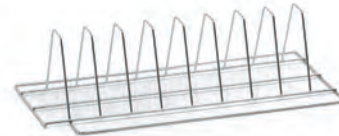

INSERT FOR 8 TRAYS (40 MM SLOTS).

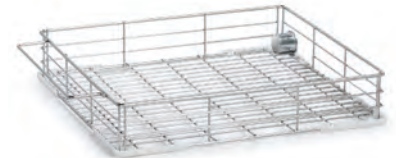

STANDARD LOAD BASKET.

## ACCESSORIES



LOAD BASKET WITH 4 WAND HOLDERS,  
5 INJECTORS FOR HOLLOW ITEMS AND 2  
CONNECTIONS FOR ASPIRATION TUBES.

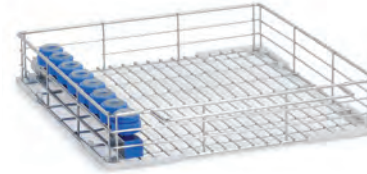

LOAD BASKET WITH 8 WAND HOLDERS.

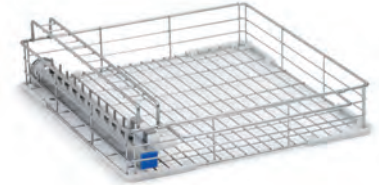

LOAD BASKET WITH 11 INJECTORS FOR  
HOLLOW ITEMS AND 2 CONNECTIONS  
FOR ASPIRATION TUBES.



NET BASKET DIN 1/2.



NET BASKET DIN 1/1.



NET BASKET FOR RIGID INSTRUMENTS.



TURBINE ADAPTOR.



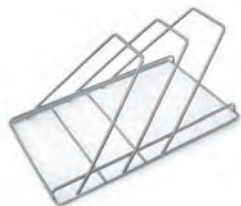

INSERT FOR 2 INSTRUMENT CONTAINERS OR TRAYS (50 MM SLOTS).

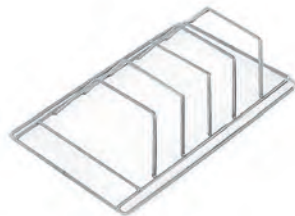

INSERT FOR 4 CONTAINERS OF INSTRUMENTS (35 MM SLOTS).



ADAPTER MALE THREAD M3  
ADAPTER FEMALE THREAD M3 X 0.5  
ADAPTER FEMALE THREAD M3.5 X 0.6  
INJECTOR



EXTERNAL THERMAL PAPER PRINTER.



EUROCLEAN 120 - 3 LT  
ENZYMATIC DETERGENT FOR MECHANIC  
WASHING OF MEDICAL DEVICES.



EUROBRIGHT 360 - 3 LT  
RINSING LIQUID, LUBRICANT FOR MEDICAL  
EQUIPMENT AND DEVICES IN THE WASHING  
MACHINE.



THE DATALOGGER TRANSFERS REGISTERED  
DATA FROM THE THERMODESINFECTOR TO  
THE PC FOR A COMPLETE DATA TRACEABILITY  
GUARANTEED.

## TECHNICAL INSIGHT



### ● AUTOMATIC DETERGENT DISPENSER

THE CHEMICAL DETERGENT IS INJECTED DIRECTLY INTO THE WASHING CHAMBER BY A PERISTALTIC PUMP THAT IS CONTROLLED BY THE SYSTEM. THIS ALLOWS THE THERMAL DISINFECTOR TO PRECISELY, AUTONOMOUSLY DISPENSE THE EXACT AMOUNT REQUIRED, THUS PREVENTING UNNECESSARY WASTE.

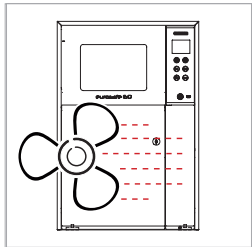

### ● FORCED HOT AIR DRYING

ALL OF THE PRESET THERMAL DISINFECTION CYCLES END WITH A DRYING STAGE: A POWERFUL BLOWER AND A HEATING ELEMENT ARE USED TO BLAST HOT AIR INTO THE WASHING CHAMBER FROM A NUMBER OF POINTS IN ORDER TO ENSURE THAT THE LOAD IS PERFECTLY DRY. AN OPTIONAL HEPA FILTER IS AVAILABLE FOR ANYONE WHO WANTS TO GUARANTEE TOTAL SAFETY.



### ● PASSWORD-PROTECTED PERSONAL CYCLES

THE THERMAL DISINFECTOR COMES WITH 20 PRESET CYCLES, EACH OF WHICH HAS DIFFERENT STAGES FOR OPTIMUM ADAPTATION TO THE WASHING REQUIREMENTS. IN ADDITION, IT IS POSSIBLE TO CREATE AND SAVE ANOTHER 20 CUSTOMIZED CYCLES. THE CYCLE CREATION AND MODIFICATION SYSTEM IS PASSWORD PROTECTED.

## TECHNICAL INSIGHT



### ● WASHING INJECTION SYSTEM

A STRONG WASHING PUMP ENSURES HIGH VOLUME WATER FLOWS IN THE CHAMBER BY DIFFERENT ACCESS POINTS ENSURING EXCELLENT WASHING RESULTS.  
THE WATER SYSTEM HAS A THREE LEVE FILTRATION SYSTEM.



### ● CYCLE TRACEABILITY WITH MANAGEMENT SOFTWARE

AT THE END OF EVERY CYCLE, THE THERMAL DISINFECTOR CREATES A FILE CONTAINING ALL OF THE DATA ABOUT THE PROCESS AND VALIDATING THE LOAD IF THE TEMPERATURES RECORDED MEET THE REQUIREMENTS. THIS FILE CAN BE TRANSFERRED TO A COMPUTER WITH A USB FLASH DRIVE OR AN ETHERNET CONNECTION AND READ BY THE MANAGEMENT SOFTWARE, THUS ENABLING STAFF TO MONITOR ALL OF THE PROCESSES THAT TAKE PLACE IN THE STERILIZATION ROOM.

# TECHNICAL DATA

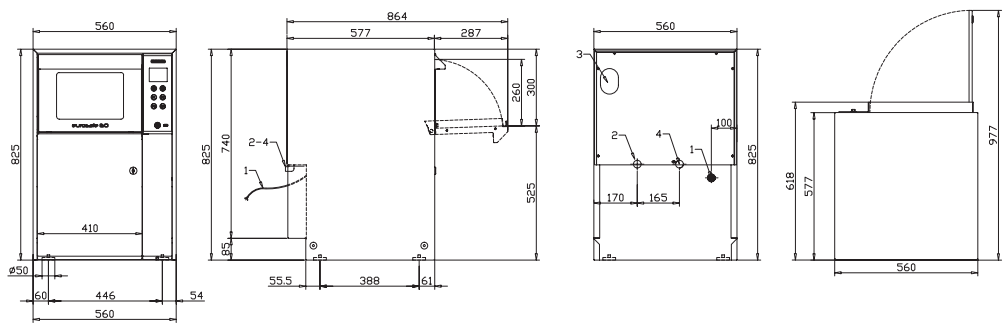

OVERALL DIMENSIONS	560 x 825 x 577 mm (L x H x D)
WEIGHT (machine empty with basket and trays)	62 kg
POWER SUPPLY	230V/~ /50Hz
TOTAL POWER	2750 W
PUMP POWER	150 W
NOISE LEVEL	< 70 dB(A)
OPERATING TEMPERATURE	+5°C / +40°C
FAN CAPACITY	fino a 100 m <sup>3</sup> /h
POWER OF HEATING ELEMENTS FOR DRYING	750 W

## SAFETY DEVICES

- Short-circuit protection
- Overheating protection
- Accidental door opening protection
- Process validation system

## DOCUMENTATION

- Installation and user manual
- Warranty certificate
- Installation chart

## COMPLIANCE WITH HARMONIZED STANDARDS

- 93/42/EEC, as amended (Medical Device Directive)
- 2006/95/EC (Low Voltage Directive)
- 2004/108/EC (Electromagnetic Compatibility Directive)
- CEI EN 61010-1 (Safety)
- CEI EN 61010-2-040 (Safety)
- 2011/65/EU (RoHS II)

## CERTIFICATIONS

- ISO 14971 (Risk Management for Medical Devices);
- IEC 61326-1 (Electromagnetic Compatibility);
- ISO 15883-1 (Washing Performance);
- ISO 15883-2 (Washing Performance);
- ISO/TS 15883-5 (Washing Performance);





#### EURONDA SPA

Via dell'Artigianato, 7

36030 Montebelluna Precalcino (Vicenza) - Italy

tel. +39 0445 329811 - fax +39 0445 865246

info@euronda.com - www.euronda.com

#### Deutschland

EURONDA DEUTSCHLAND GMBH

Am Landwehrbach, 5

48341 Altenberge - Deutschland

tel. +49 2505 9389 0 - fax +49 2505 9389 29

info@euronda.de - www.euronda.de

#### España

EURONDA SPA

IDENTYD - Av. Cabezo de Torres, 4, local

30007 Murcia - España

Atención al cliente: 900102034

info@euronda.es - www.euronda.es

#### France

EURONDA FRANCE

ZAC Les Vallées - Avenue de Bruxelles

60110 Amblainville - France

tél. +33 (0)3.44.06.69.70 - fax +33 (0)3.44.02.03.89

info@euronda.fr - www.euronda.fr

#### Russia

OOO FINSTAR

5/2a Varshavskaya str.

196128, St. Petersburg - Russia

info@finstartech.ru